

The Xone:23C DJ Mixer ships with Mixvibes Cross LE DJ Software, providing DVS control and plug n'play mapping for Xone:K Series controllers.

The default mapping for the Xone:K Series controllers with Mixvibes Cross LE offers extended software control.

Instructions for Xone:K1 with Cross LE.

1. Connect the computer to the Xone:23C mixers USB Soundcard.
2. From the rear of the Xone:K1, connect the X:LINK OUT to the Xone:23C mixers X:LINK.

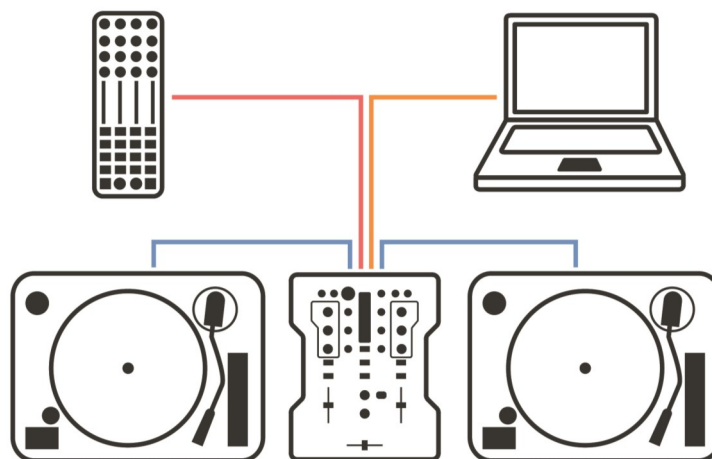

- A. By default the K1 ships on MIDI channel 15, which this map is assigned to.
- B. If you need to change the MIDI channel:

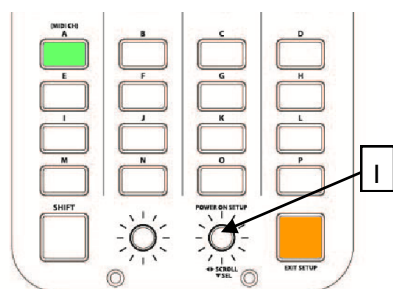

1. Press and hold down the encoder [1], then power up by plugging the X:LINK cable.
2. The switch matrix LED's will flash RED three times to indicate that the K1 has entered setup mode.



The display will default as above, with Switch 'A' (the MIDI CHANNEL setup option) being illuminated. Press the setup encoder [1] to display the current MIDI channel number.

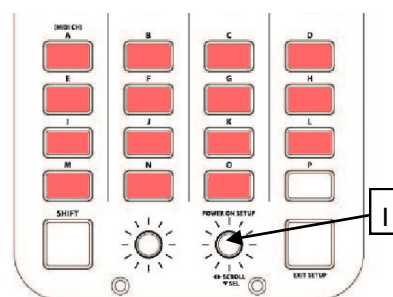

1. The channel number is represented by the number of illuminated switches; in this case MIDI Channel 15.
2. To change the MIDI Channel number, rotate the Setup encoder.
3. Once the desired MIDI Channel Number has been chosen, press the Setup Encoder [1] to store it and return to the setup mode.
4. Press the amber switch to exit setup mode and the switch matrix LED's will flash RED three times.

